

Hilton Waikiki Prince Kuhio Hotel

Meeting Space Capacity and Banquet Layouts

The Hilton Waikiki Prince Kuhio gives you a great Waikiki location, flexible facilities, and famous island-style hospitality. 8,033-square-foot Grand Ballroom on the third floor can accommodate 550 people from trade shows to lavish gala dinners. 2,100 square feet of meeting space is available on the floor directly above the ballroom on the fourth floor. These three additional rooms are excellent for private meetings, and breakout rooms. All meeting rooms are equipped with Internet access. Our new Hawaii Ballroom, Maui, Kauai, Molokai and Niihau Board Room on the second floor mezzanine level have another 4,790 square feet of executive meeting space. Either the parking or guest elevators can easily access any floor, with facilities close by. The Hilton Waikiki Prince Kuhio Catering staff's innovative ideas will help make any meeting a success giving attention to every detail.

Room Name	Dimensions	Square Feet	Ceiling Height	Theatre	Classroom	Banquet	Reception	Conference	U-Shape
Prince Kuhio Ballroom	112' x 73'	8033	12'	825	550	550	825	-	-
Pre-Function – Foyer		2200	8'	-	-	-	-	-	-
Two room Division Queen Kaahumanu	55' x 73'	4015	12'	380	200	260	400	-	-
Queen Emma	56' x 73'	4080	12'	440	200	300	400	-	-
Three room Division Prince Edward	36' x 73'	2628	12'	190	120	180	190	-	-
Prince David	35' x 73'	2555	12'	190	120	180	190	-	-
Prince Jonah	41' x 73'	2993	12'	190	150	180	190	-	-
Four room Division Queen Kaahumanu	55' x 73'	4015	12'	380	200	260	400	-	-
Kalulani I	41' x 22'	902	8'	50	40	50	60	35	-
Kalulani II	40' x 28'	1120	12'	80	60	90	70	45	-
Kalulani III	44' x 22'	880	12'	60	40	50	60	35	-
2 nd Floor Hawaii Ballroom	66'3" x 21'	1394	7'	90	50	90	-	50	40
Hawaii I	36'3" x 21'	764	7'	50	30	50	-	25	25
Hawaii II	30' x 21'	630	7'	40	24	40	-	25	25
Maui	29' x 35'	1015	7'	75	40	70	70	30	30
Kauai	43'5" x 25'5"	1116	7'	55	40	50	-	30	30
Molokai	36' x 23'	828	7'	50	30	50	-	28	30
Niihau Board Room	17'5" x 25'	437	7'	-	-	-	-	15	-
Fourth Floor: Maile Room	68' x 20'	1360	7'6"	100	70	100	110	60	35
Maile I	34' x 20'	680	7'6"	50	35	50	55	30	-
Maile II	34' x 20'	680	7'6"	50	35	50	55	30	-
Lehua	37' x 20'	740	7'6"	50	35	50	55	30	-

Hilton Waikiki Prince Kuhio Hotel

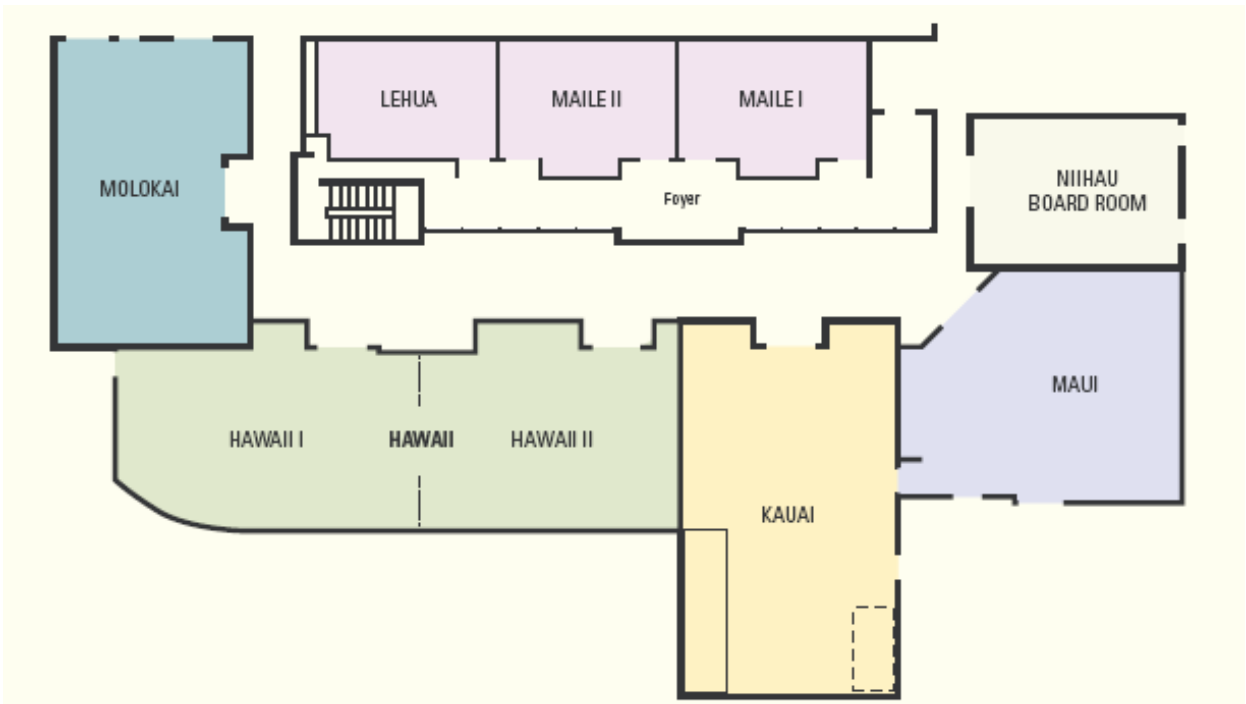
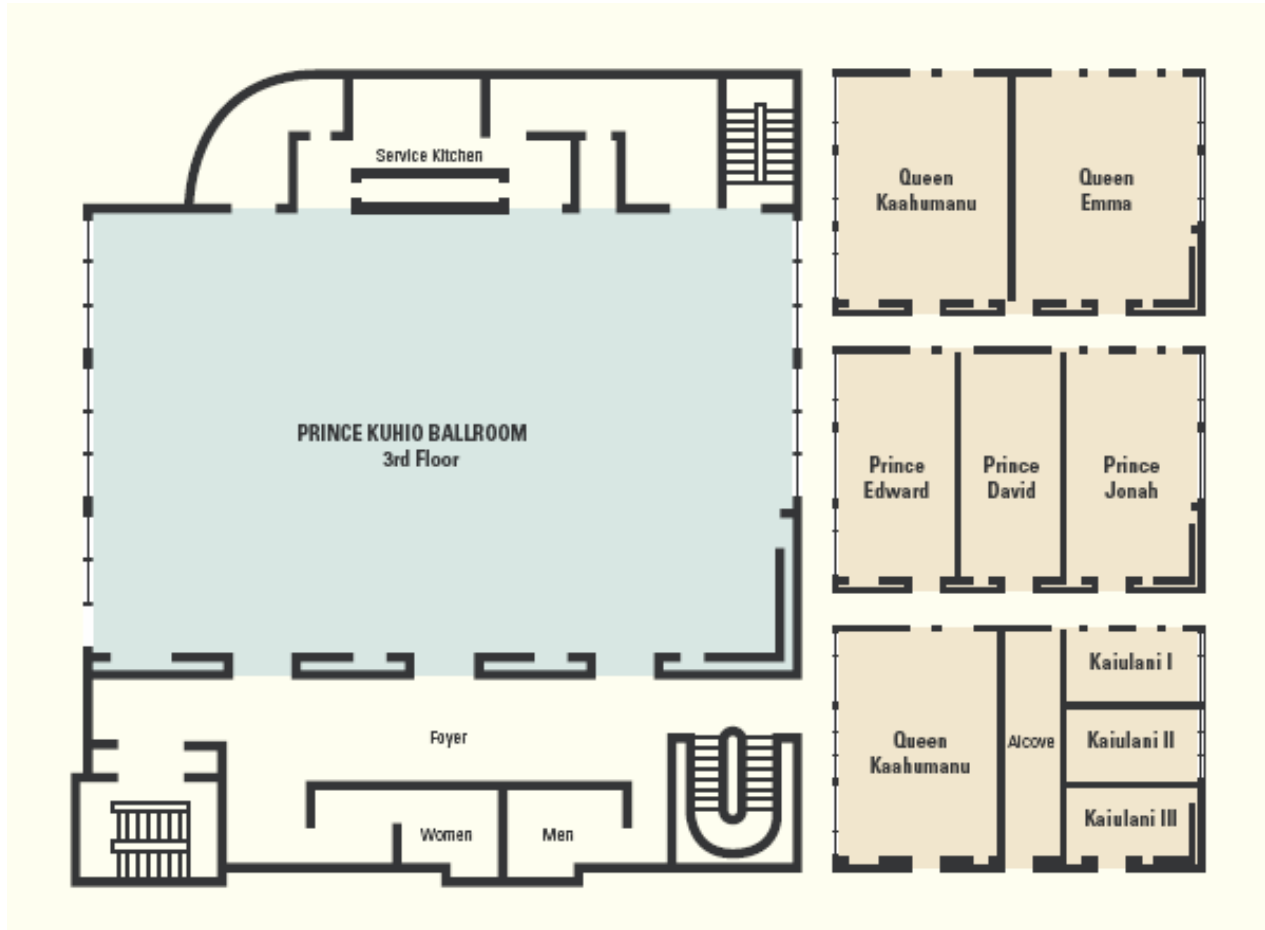

Hilton Waikiki Prince Kuhio – 2500 Kuhio Ave, Waikiki Beach, HI 96815